

## Outdoor Bug Eye Dual Head Emergency Light



**90 Mins Battery Back-Up**

## Product Description:

This LED Emergency Light is safe for outdoor use. It has a plastic cover that protects it from rain and snow. These lights are widely used outside of offices, hotels, and other businesses. It is suitable for 32°F-104°F harsh environments

## Features

- Injection-molded thermoplastic ABS housing 5VA flame rating.
- innovative, easy installation in minutes.
- Suitable for wall mount applications.
- Wet location listed
- 2\*1.2W led lamp heads.6500K
- Universal J-box mounting pattern.
- 120/277VAC dual voltage operation.
- Built-in 3.6V 700mAh rechargeable NiCd battery for minimum 90 minutes emergency operation.
- Maximum 24 hours for full recharge time.
- Test switch and charge indicator.

## Dimensions

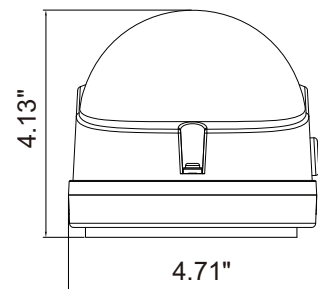
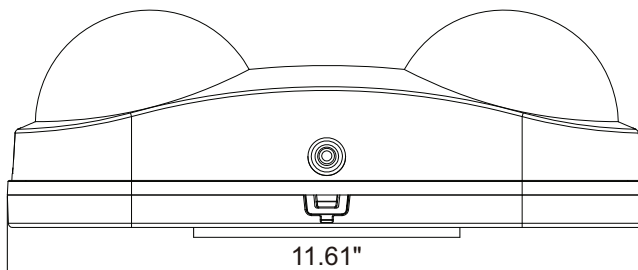

## Test Button Installation

1. Loosen the screws on the housing



2. Remove the housing from the light base



3. Connect wires with external power supply



4. Connect the battery terminal

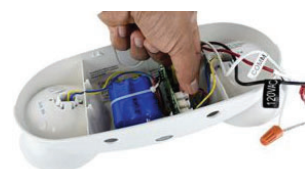

## Specifications

Product Number	Information	Certifications	Dimmable	Voltage	Working Hours
E2-STEVO10-IP65	2x12pcs SMD 2835 LED lamp heads	UL Wet LOCATION LISTED	NO	120-277V	EMERGENCY MODE-90min.

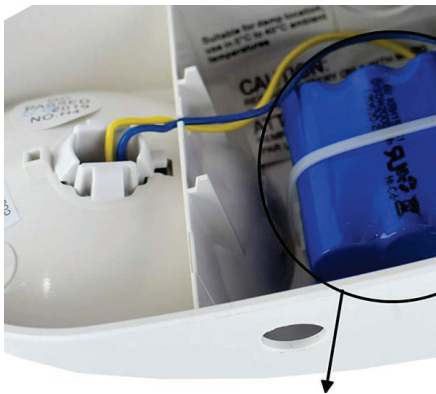

**700mAh Large CAPACITY**  
24hrs charging for at least 90mins emergency lighting



\*must connect internal battery before fixture installation